

Airport Information for 2,818 +/- Acre

Rough Creek Ranch

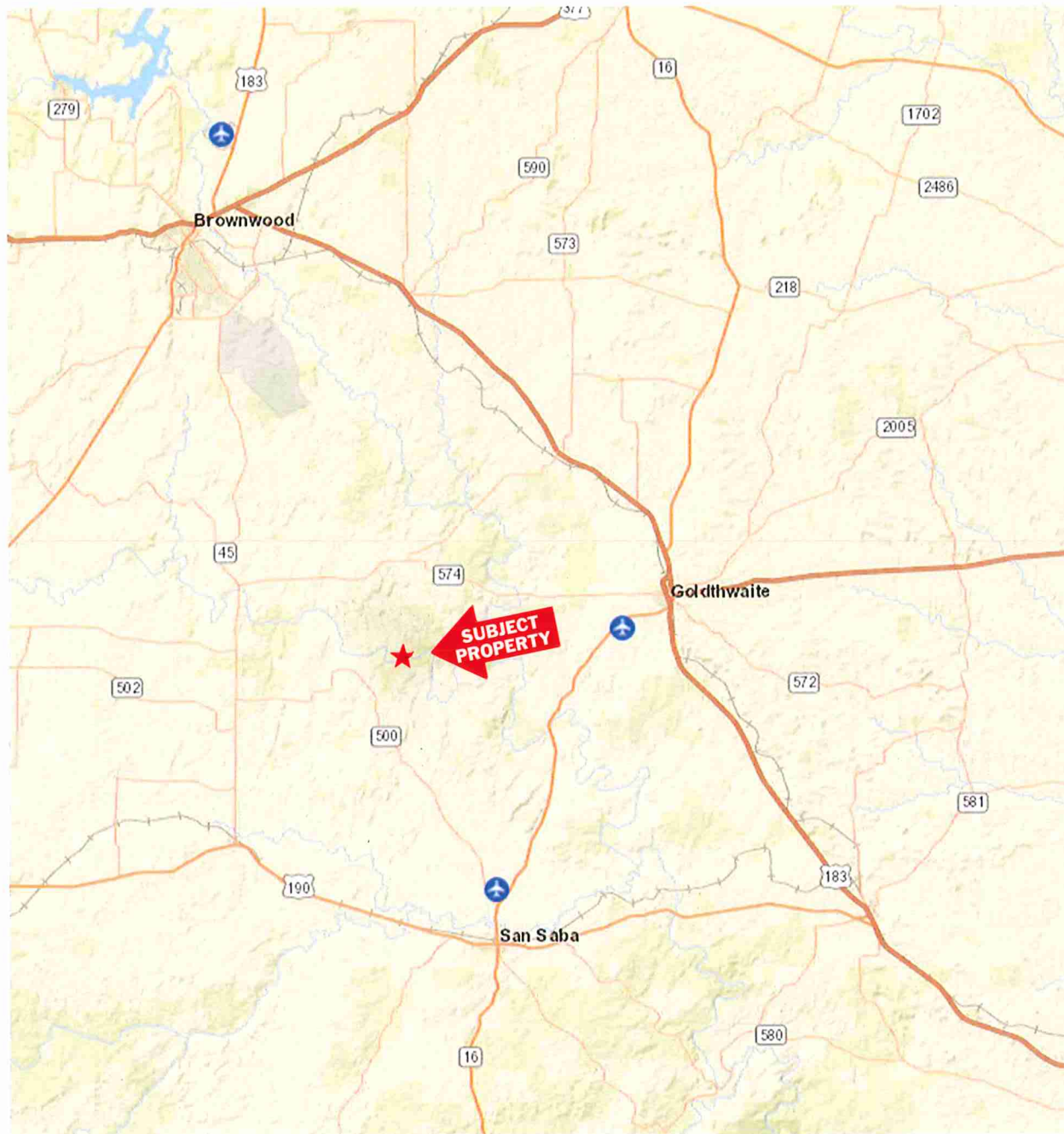

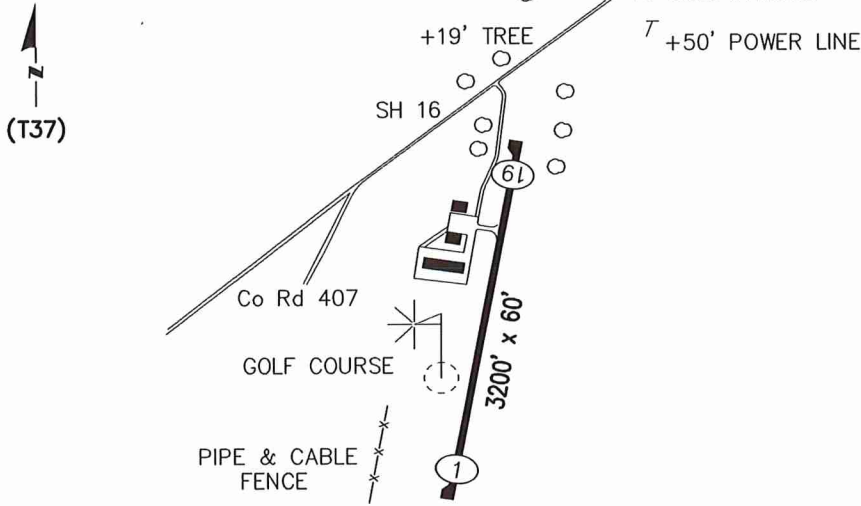

Lat: N 31° 25.74' **Elev:** 1457' MSL **Sectional:** SAN ANTONIO
Lon: W 98° 36.50' **TPA:** STD **Downtown to Apt:** 2.4 nm/SW

Owner: CITY OF GOLDTHWAITE **Manager:** ROBERT LINDSEY
 P O BOX 450 1218 FISHER ST
 GOLDTHWAITE TX 76844 GOLDTHWAITE TX 76844
Phone: 325-648-3186 325-648-3186
Fax: 325-648-2570 **Email:** citymgr@centex.net
Web: www.centex.net/~city/

ATTENDANCE SCHEDULE: 8:00AM-5:00PM

FUEL: NONE

REPAIRS: Airframe: NONE Power Plant: NONE

LIGHTS: NONE **CTAF:** 122.9

REMARKS: NONE

FIXED BASE OPERATORS: NONE



UPDATED: 3/31/2014

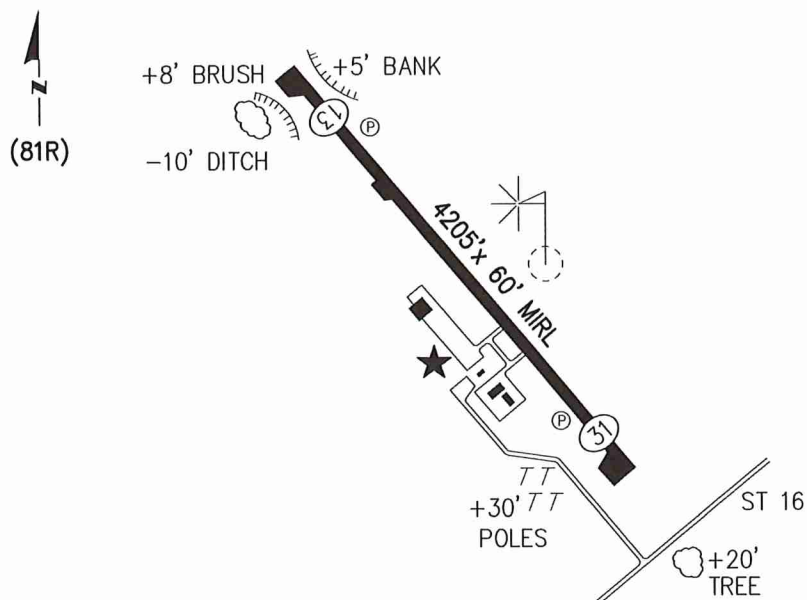

Lat: N 31° 14.11'
Lon: W 98° 43.02'

Elev: 1249' MSL
TPA: STD

Sectional: SAN ANTONIO
Downtown to Apt: 03 nm/N

Owner: SAN SABA CITY COUNTY
500 E. WALLACE
SAN SABA TX 76877
Phone: 325-372-5144

Manager: STEVE DYER
567 CR 105
SAN SABA TX 76877
325-372-3380

ATTENDANCE SCHEDULE: UNATTENDED

FUEL: 100LL & JET A (SEE REMARKS)

REPAIRS: Airframe: NONE Power Plant: NONE

LIGHTS: DSK-DWN RDO/CTL

UNICOM/CTAF: 122.8

REMARKS: FOOD-LODGING (2 MI); FUEL EMERGENCY USE ONLY CALL 325-372-3722; JET A AVAILABLE FOR HELICOPTORS ONLY; NO TRANSPORTATION AVAILABLE

FIXED BASE OPERATORS: MARK DYER 325-372-6034/3380

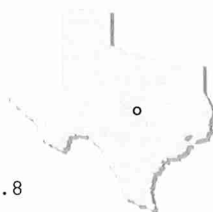

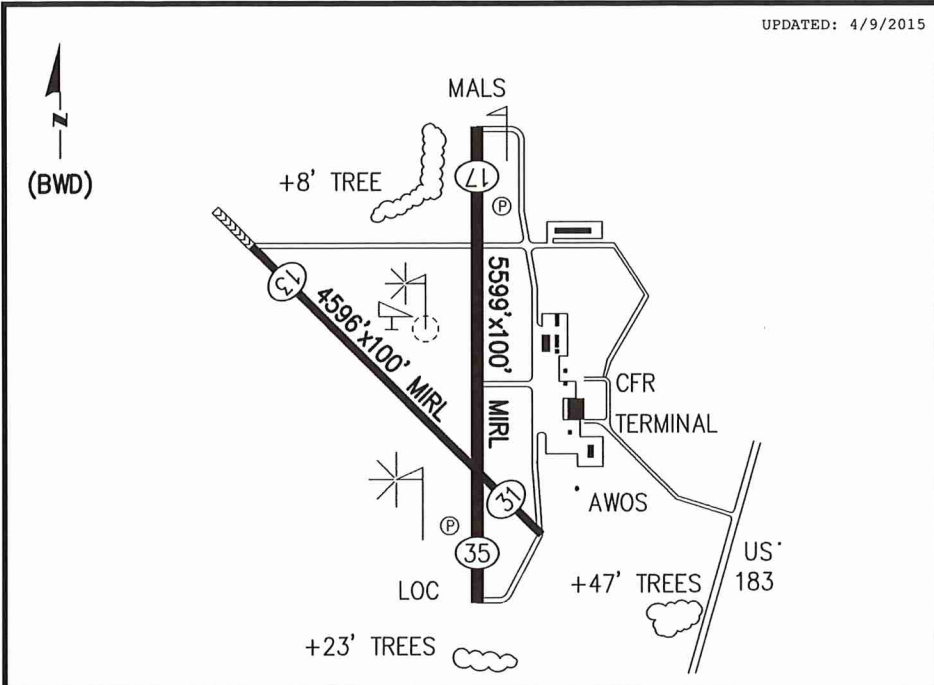

Lat: N 31° 47.62' Elev: 1387' MSL Sectional: SAN ANTONIO
 Lon: W 98° 57.39 TPA: STD Downtown to Apt: 05 nm/N

Owner: CITY OF BROWNWOOD **Manager:** BOBBY BURKS
 BOX 1389 BOX 1389
 BROWNWOOD TX 76804 BROWNWOOD TX 76804
Phone: 325-643-1482 325-643-1482
Fax: 325-643-3162 **Email:** bburks@ci.brownwood.tx.us

ATTENDANCE SCHEDULE: MON-FRI 7:00AM-8:00PM
 SAT-SUN 7:00AM-5:00PM

FUEL: JET A 100LL (SEE REMARKS)

REPAIRS: Airframe: MAJOR Power Plant: MAJOR

LIGHTS: DSK-DWN RDO/CTL **UNICOM/CTAF:** 122.8

AWOS: 118.325 / 888-297-9399

REMARKS: FOOD-LODGING(5 MI); TAXI; RENT CAR; COURTESY CAR; VENDING
 MACHINES; FLT INST; PILOT LOUNGE; WEATHER; WIRELESS
 INTERNET; 24HRS SERVICE FOR 100LL & JET A; FOR FUEL
 AFTER HOURS, CALL 325-642-1482

FIXED BASE OPERATORS: CITY OF BROWNWOOD RGNL APT 643-1482 OR 642-4154

